

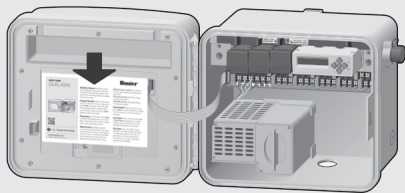

## HELP CARD

# DUAL48M



 <http://hunter.direct/dual>

[hunterindustries.com](http://hunterindustries.com)

LIT-662 DUALHELPCARD 9/15

**Available Stations:** Numbers of stations available for decoder operation. If ICM-600 modules are present, this shows the remaining stations available for Dual decoders.

**Program Decoder:** Place red and blue wire from decoder into port holes and press **Enter**. Dual will “read” decoder. Enter desired station numbers with up and down arrows, and press **Enter** (Save) to send to decoder.

**Diagnostics:** If controller shows **Fault**, use DUAL48M Diagnostics to investigate. If the Fault has a station number, start station and read current.

**Read Current:** Standby decoders use approximately 3mA current, each. Divide total current by 3 to get approximate number of decoders in system. Each solenoid on a station will use approximately 40mA when active.

# Hunter®

**(Read Current, cont’d):** Turn station on, and read Current to verify proper operation.

**Too much current** = decoder wiring or solenoid problem.

**Too little current** = solenoid wiring or decoder problem.

**Find Solenoid:** Select a station, then press **Start** to cause solenoid to chatter for 60 seconds, so it can be heard in the field.

**Line Fault:** Short in the two-wire path. If **Line Fault** only appears on certain stations, there may be short in the wiring from decoder to solenoid.

**Line Open:** Two-wire path is open between controller and first decoder. This may also appear with only 1-3 decoders on the wire path due to fluctuations in current, until more decoders are installed.

<b>DUAL TEXT</b>	<b>DEFINITION</b>	<b>DUAL TEXT</b>	<b>DEFINITION</b>
<b>Ready</b>	Normal, ready to irrigate	<b>No Communication</b>	Dual does not recognize I-Core facepack
<b>Avail Stations</b>	Range of stations available to program to decoder addresses	<b>Slot</b>	Slot in cabinet for modular output modules—each one has a number
<b>Prog Decoder</b>	Program a Decoder address into the decoder	<b>Unknown Slot Address</b>	Module not properly inserted; pin is bent or hardware malfunction
<b>Save</b>	Send the address to the decoder	<b>Running Stations</b>	Displayed when decoder stations are active
<b>Reading...</b>	Dual is trying to read the decoder	<b>Unable to Run</b>	Dual prevented a station from running due to high current
<b>Decoder Not Detected</b>	Reading was unsuccessful either because there is no decoder, or decoder is bad	<b>Resuming...</b>	Dual is about to restart the two wire path
<b>Programming...</b>	Shown while sending the address to the decoder	<b>ERROR</b>	Problem programming decoders, or no decoder found in programming port
<b>Done</b>	Completed successfully	<b>Out of Range</b>	Invalid decoder address, station number already assigned to ICM-600 module
<b>Diagnostics</b>	Troubleshooting tools	<b>Duplicate Addr</b>	Multi-station decoder has same address on both stations
<b>Read Current</b>	Reads the output current in milliamps	<b>Decoder Not Supported</b>	Decoder type not supported by Dual
<b>Find Solenoid</b>	Locate a solenoid (chatter function)	<b>Address Not Set</b>	There was a problem during the address write (check wiring)
<b>Find Stn</b>	Enter the station number to be found	<b>Contrast...</b>	Change screen contrast (hold Enter button for 3 seconds)
<b>Start</b>	Begin chatter function	<b>Capacity Exceeded</b>	Two wire path current too high
<b>Stop</b>	Stop chatter function	<b>Finding Stn</b>	Displayed during Find Solenoid function
<b>Back</b>	Return to previous menu		
<b>Clear</b>	Erase the entry to start again		
<b>Line Open</b>	Two-wire path is cut or open, not connected		
<b>Line Fault</b>	Two-wire path or solenoid wiring has a short circuit		